

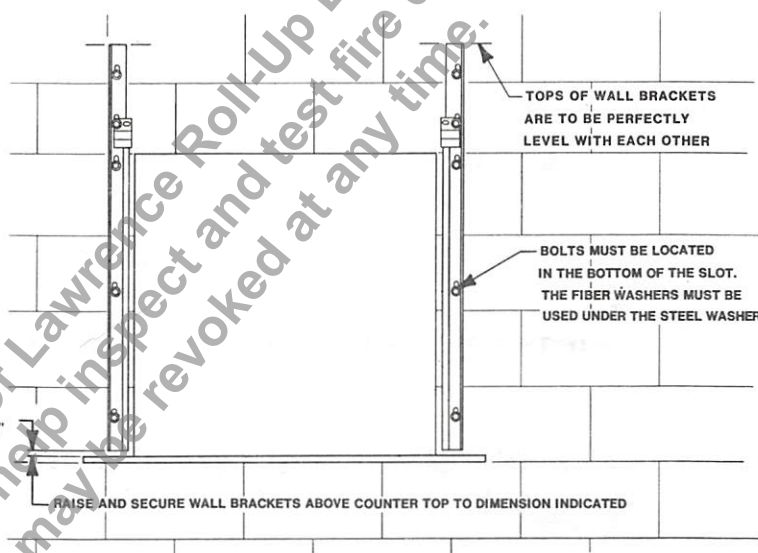
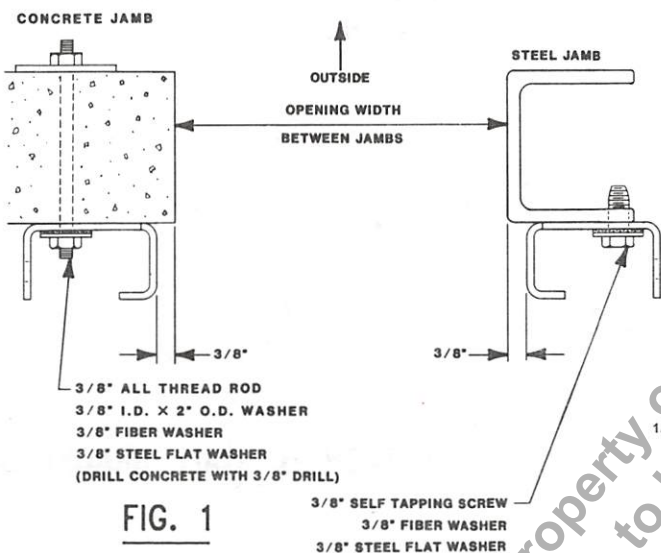
# FIRE COUNTER SHUTTER FACE MOUNTED DOORS

## WARNING

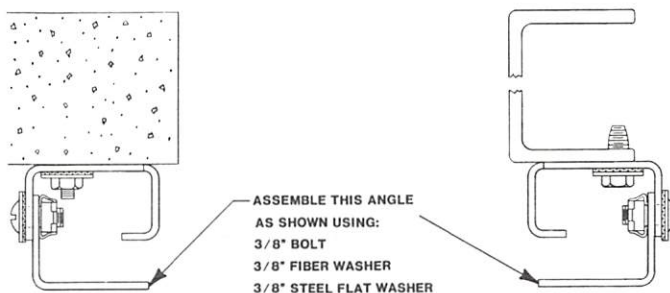
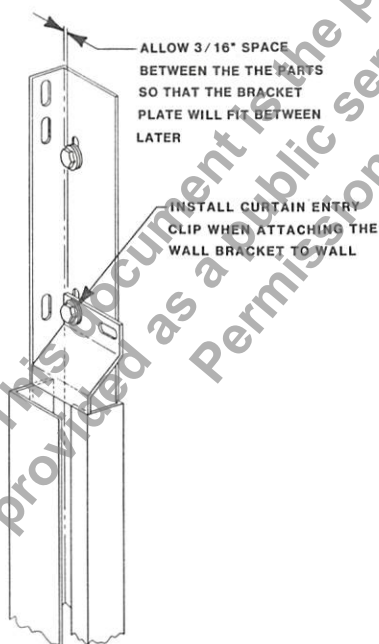
PERSONAL INJURY CAN RESULT FROM INEXPERIENCED PEOPLE WORKING ON THIS DOOR. ONLY EXPERIENCED, QUALIFIED ROLLING DOOR SERVICE PERSONNEL SHOULD INSTALL, DO REPAIR WORK OR MAKE ADJUSTMENTS TO THE DOOR.

NOTE: FOR BETWEEN JAMB MOUNTED DOORS, SEE STEP 1A ON SEPARATE SHEET.

**STEP 1** INSTALL WALL BRACKETS TO JAMBS. SEE FIGURE 1, 2, & 3. SEE FIGURE 3 BEFORE INSTALLING SECOND ANCHOR FROM TOP.



**STEP 2** BOLT GUIDE ANGLES TO WALL BRACKETS AS SHOWN IN FIGURE 4.

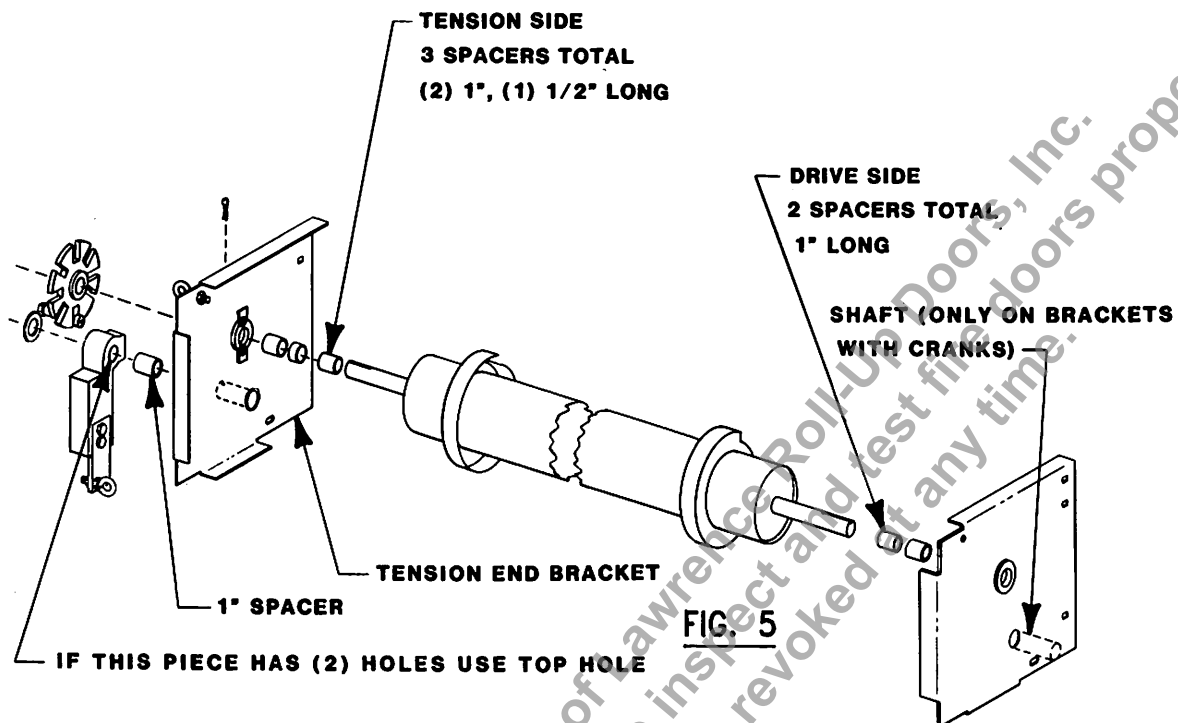


**WINDSOR DOOR**  
A United Dominion Company

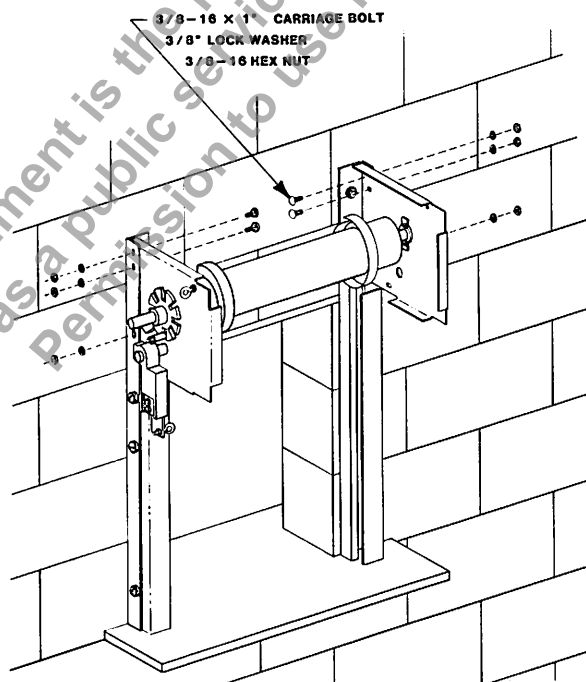
5800 Scott Hamilton Drive  
Little Rock, Ar. 72209  
1370 Furneaux Road  
Marysville, Ca. 95901

**STEP 3** PLACE BRACKETS ON BARREL AS SHOWN IN FIGURE 5.

**NOTE:** THE SHAFT IN THE TENSION END OF THE BARREL WILL ROTATE WITHOUT THE BARREL TURNING.

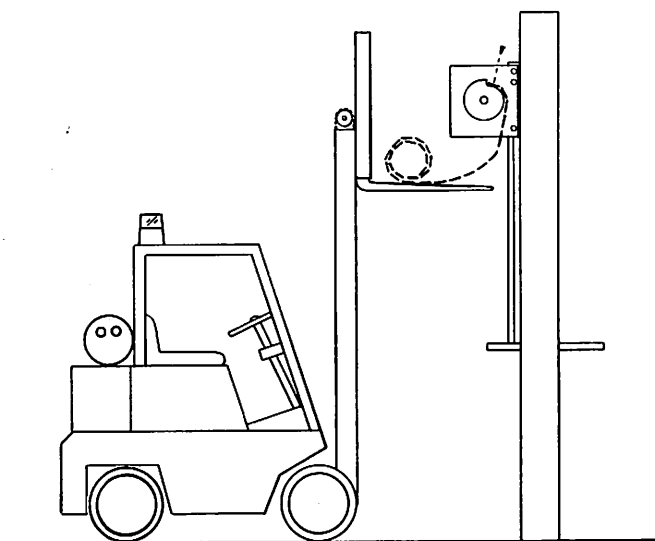


**STEP 4** RAISE THE BARREL AND BRACKETS INTO POSITION AND ATTACH TO WALL BRACKETS OR CHANNELS AS SHOWN IN FIGURE 6.

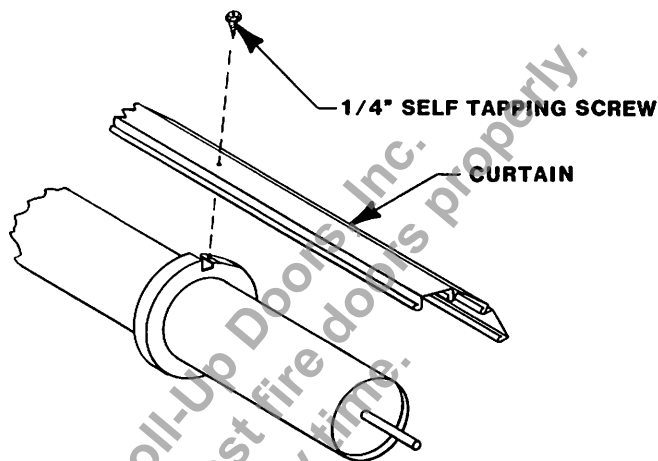


**FIG. 6**

**STEP 5** RAISE THE CURTAIN INTO POSITION AND ATTACH TOP SLAT TO BARREL HOOPS AS SHOWN IN FIGURES 7 AND 8. BEFORE DRILLING THROUGH SLATS AND HOOPS BE SURE THAT THE CURTAIN IS CENTERED BETWEEN THE BRACKET PLATES.



**FIG. 7**

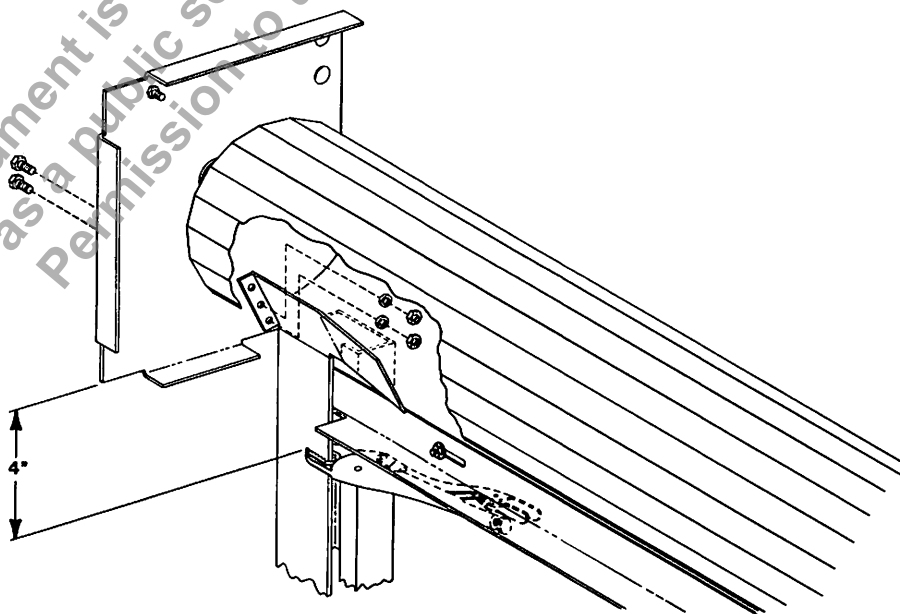


**FIG. 8**

**STEP 6** WHEN THE CURTAIN IS ATTACHED, ROLL THE BARREL UNTIL THE ENTIRE CURTAIN IS WRAPPED UP.

**STEP 7** ATTACH A PAIR OF VISE GRIPS ON BOTH GUIDES AND LOWER THE CURTAIN INTO GUIDES UNTIL BOTTOM BAR RESTS ON VISE GRIPS ON BOTH SIDES OF THE DOOR. SEE FIGURE 9.

**STEP 8** BOLT THE INSIDE CURTAIN STOPS TO THE BRACKETS USING 1/4" X 5/8" HEX HEAD BOLTS. SEE FIGURE 9.



**FIG. 9**

**STEP 9** POSITION TENSION WHEEL FROM BRACKET SO THAT THE HEAD OF THE 7/16 INCH DIAMETER CAP SCREW IS TOUCHING THE BRACKET. BE SURE THAT THE 1/4" SQUARE KEY IS IN PLACE AND TIGHTEN THE SET SCREWS IN THE TENSION WHEEL. WIND THE SPRINGS IN A DOWNWARD DIRECTION AS SHOWN IN FIGURE 10.

WIND SPRINGS \_\_\_\_\_ TURNS.

### CAUTION

"USE OF OTHER TOOLS OR BARS THAN SHOWN FOR WINDING SPRINGS COULD BE DANGEROUS".

AFTER SPRINGS ARE WOUND ALLOW (1) OF THE WINDING BARS TO REST AGAINST THE OPENING JAMB.

BE SURE THAT THE BAR IS POSITIONED IN THE CENTER OF THE SLOT OF THE TENSION WHEEL AND RESTING AGAINST A FIRM SURFACE OF THE BUILDING.

REMOVE THE VISE GRIPS FROM THE GUIDES AND LOWER CURTAIN TO CLOSED POSITION. CHECK FOR PROPER BALANCE OF THE DOOR AT THIS TIME.

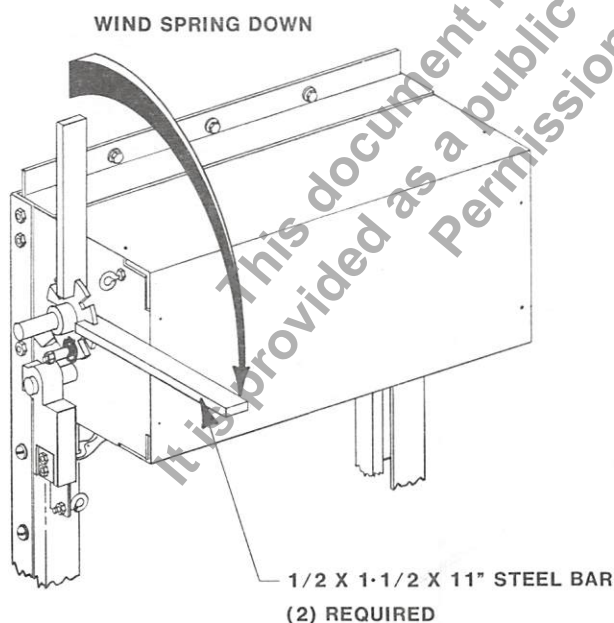
IF THE DOOR WILL NOT SET ON THE COUNTER, RAISE TO OPEN POSITION AND DECREASE SPRING TURNS BY ONE NOTCH.

### CAUTION

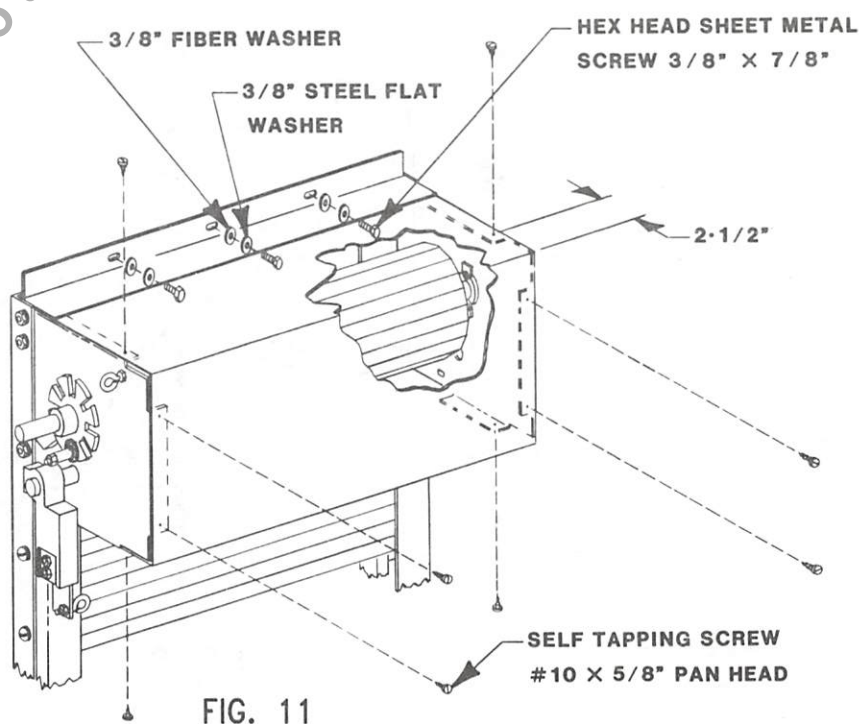
NEVER ADJUST SPRING TENSION UNLESS THE DOOR IS IN OPEN POSITION. ATTACH A PAIR OF VISE GRIPS ON BOTH GUIDES. SEE FIGURE 9.

IF THE DOOR IS HARD TO RAISE, OPEN IT AND ADD (1) NOTCH TENSION. REPEAT ADJUSTING PROCEDURES ABOVE UNTIL DOOR OPERATES SMOOTH AND EASILY.

**STEP 10** INSTALL DOOR HOOD AS SHOWN. IF DESIRED YOU CAN COMPLETE STEP 11 BEFORE DOING THIS STEP. SEE FIGURE 11 FOR FACE MOUNT DOOR.



**FIG. 10**



**FIG. 11**



## STEP 11

NOTE: IF DOOR IS CRANK OPERATED SEE STEP 13 AT THIS TIME. IF DOOR IS MOTOR OPERATED SEE STEP 13A. INSTALL EYE BOLTS INTO THE CEILING AND HOOK UP THE TENSION RELEASE LEVER AS SHOWN. HOOK UP OF CHAIN AND FUSIBLE LINKS WILL VARY WITH JOB CONDITIONS. FIG. 12 AND 12A SHOW A TYPICAL HOOK UP. NOTE: WIDER DOORS WILL REQUIRE MORE THAN (1) FUSIBLE LINK. PUT  $\frac{7}{16}$ " DIA. BOLT, BRASS BUSHING AND WASHERS IN TENSION WHEEL SO THAT IT WILL BE IN THE RIGHT SLOT THAT WILL ALLOW THE BRASS BUSHING TO REST AGAINST THE TENSION RELEASE LEVER.

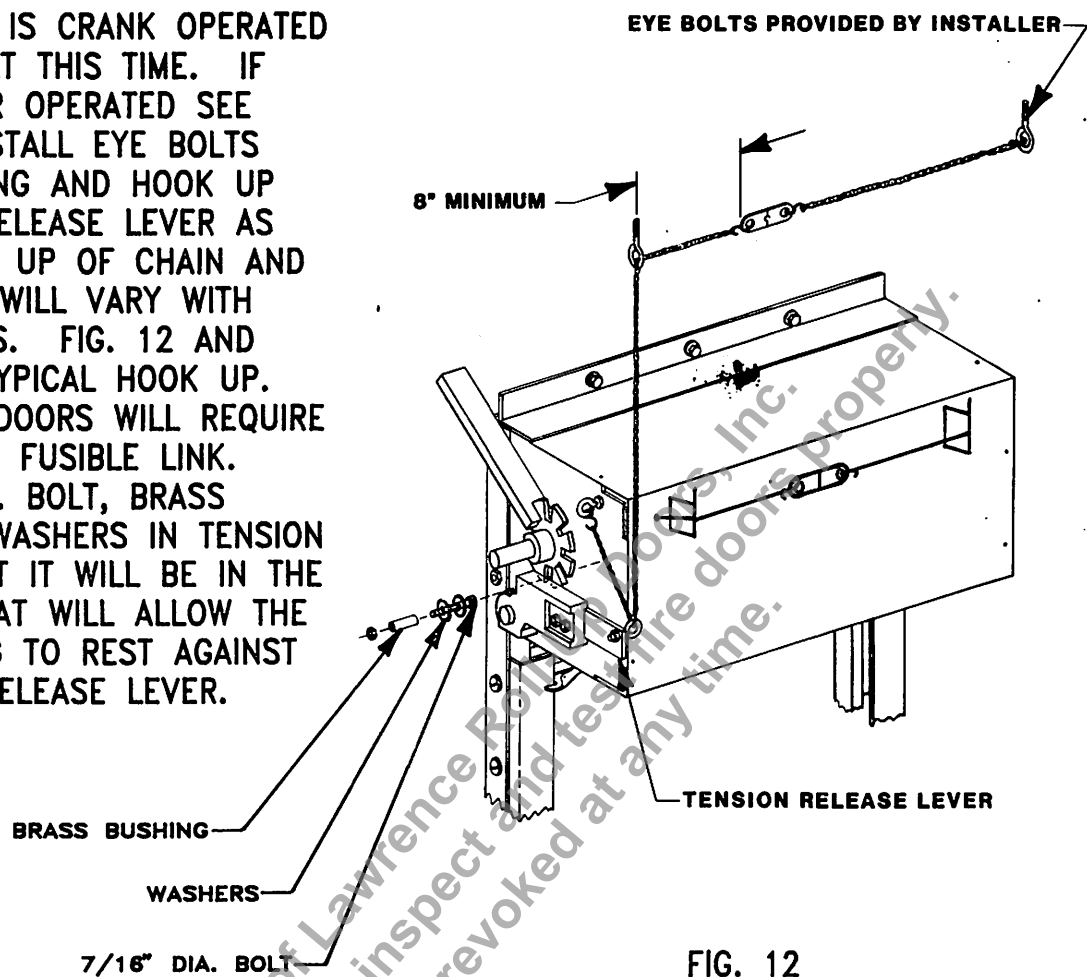


FIG. 12

## PUSH-UP DOOR

## STEP 12

NOTE: THIS IS THE MOST IMPORTANT STEP OF INSTALLATION. BEFORE INSTALLATION OF BRACKET COVERS, CHECK TO SEE IF DOOR DROPS. TO DO THIS REMOVE ONE OF THE "S"-HOOKS IN THE DROP CHAIN AND RELEASE THE CHAIN. IF THE DOOR DOES NOT DROP, ADJUST SPRING. SEE STEP 9.

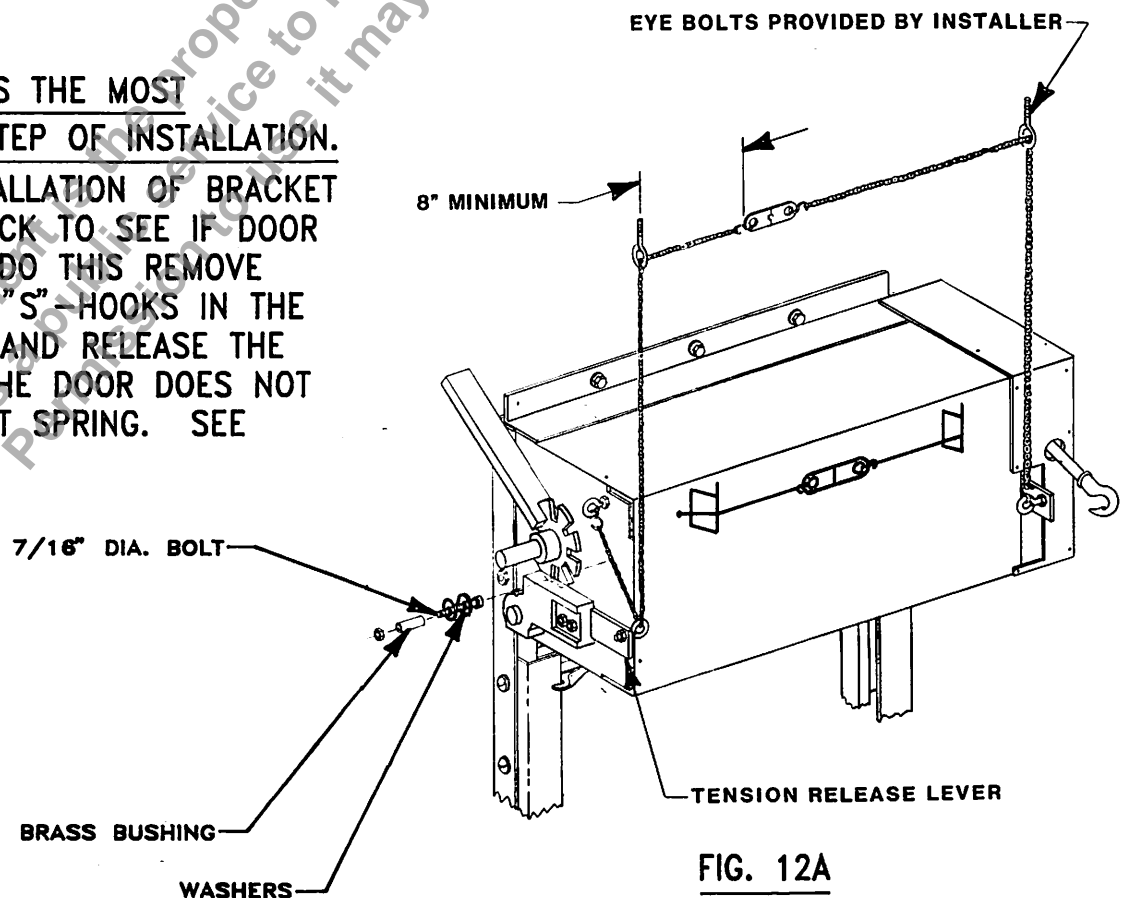


FIG. 12A

## CRANK OR MOTOR OPERATED DOOR

**FIG. 12B**

ALTERNATE FOR THRU WALL  
HOOK-UP (BE SURE RELEASE  
LEVERS ARE FREE TO FALL IF  
ANY ONE OF THE FUSIBLE  
LINKS SEPARATES).

PIPE SLEEVE  
(SUPPLIED BY  
OTHERS)

RING (SUPPLIED  
BY OTHERS)

LEAVE ENOUGH LENGTH IN CHAIN TO ALLOW  
RELEASE LEVERS TO COMPLETELY FALL.

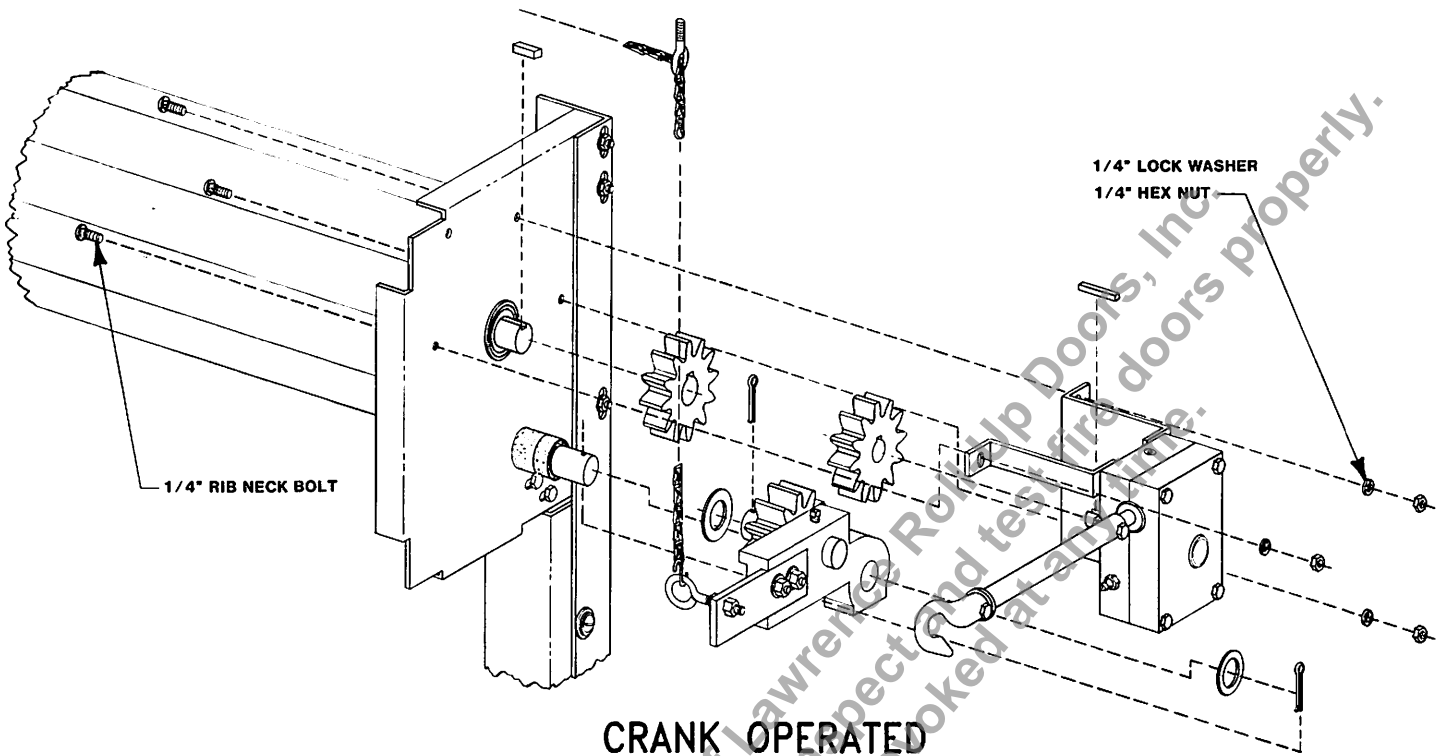
EYE BOLTS (SUPPLIED BY OTHERS).

RING (SUPPLIED BY OTHERS).

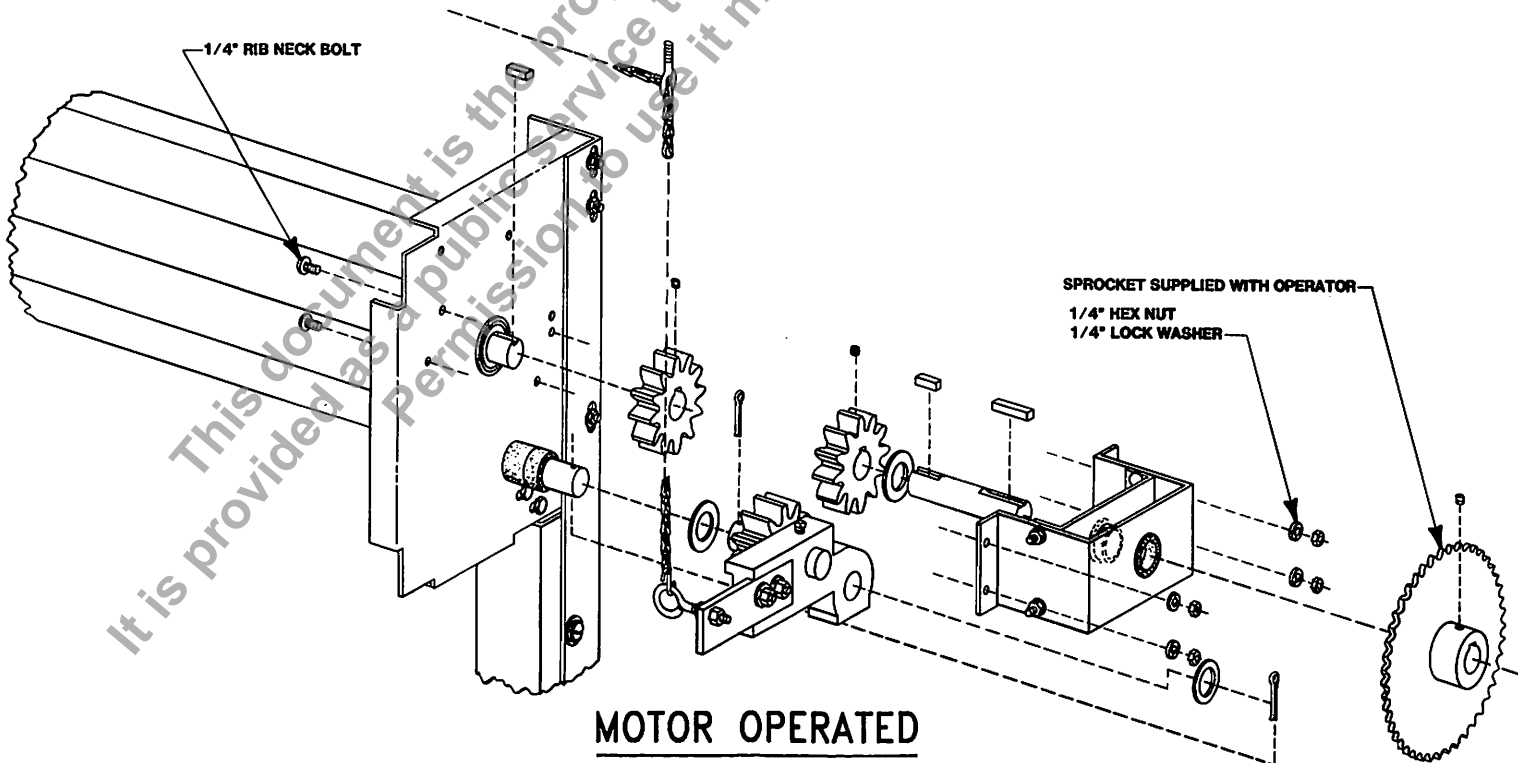
SIDE VIEW

FRONT VIEW

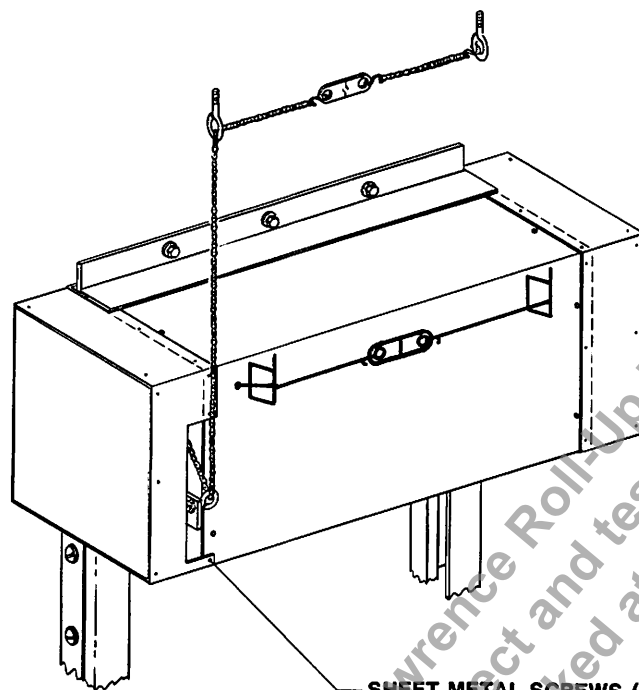
## STEP 13



## STEP 13A



**STEP 14    ATTACH END COVERS AS SHOWN.**



**SHEET METAL SCREWS (PROVIDED BY MFG.)  
(POP RIVETS PROVIDED BY INSTALLER  
ARE OPTIONAL)**

**I N S T A L L E R:    GIVE ALL INSTRUCTIONS TO THE OWNERS OR IF THAT  
IS NOT POSSIBLE, ATTACH TO THE WALL NEXT TO THE  
DOOR.**